

Mixing valve CONTROLMIX3

Three-way mixing valve

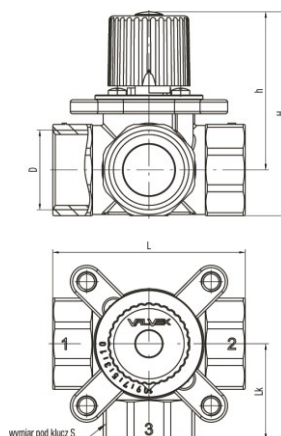

DN	Code	Dimensions						Kvs	Torque	Types of fluids	EAN13
		S	Lk	D	L	H	h				
20	6093100	31	38,5	R3/4	77	86	68	6,3 (m3/h)	<1 Nm	water, glycol (≤50%)	5902273507161
25	6094100	39	41	R1	82	87	68	12 (m3/h)	<1 Nm	water, glycol (≤50%)	5902273507178
32	6095100	49	46	R1 1/4	92	94	70	16 (m3/h)	<1 Nm	water, glycol (≤50%)	5902273526117
40	6096300	53	54,5	R1 1/2	109	101	74	25 (m3/h)	<1 Nm	water, glycol (≤50%)	5902273535225
50	6097470	68	59,5	R2	119	113	79	40 (m3/h)	<1 Nm	water, glycol (≤50%)	5902273536925

Product usage:

For use in central heating systems

Type:

Mixing valves

Guarantee:

25-year

Technical data/Operating parameters:

Nom. temperature: -10°C ÷ 110°C

Nom. pressure: 1,0 Mpa

Used materials:

body: brass,
gaskets: EPDM,
knob and scale: polyamide PA,
end cap: ABS
teflon lining,
steel screws

Finish:

body: brass