

## Series Quasar

Washbasin mixer with pop-up drain

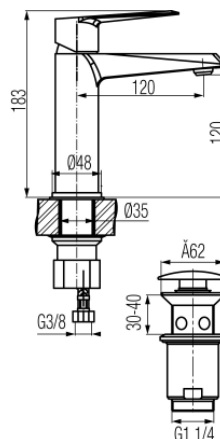

| Code    | Cartridge     | Flow class | Hoses | EAN13         |
|---------|---------------|------------|-------|---------------|
| 2446800 | cartridge Ø35 | Z          | G3/8  | 5902273510246 |
| 2446801 | cartridge Ø35 | Z          | G1/2  | 5902273514824 |

**Product usage:**

For use in with cold and hot water systems in buildings

**Type:**

Washbasin mixers

**Technical data/Operating parameters:**Recommended working pressure: 0,1-0,5 MPa,  
Max temperature: 90°C**Guarantee:**

25-year

**Used materials:**

brass

**Finish:**

chrome